

MusicMan[®] * User Manual

WiFi Multiroom Soundstation BT-X34

The manufacturer Technaxx Deutschland GmbH & Co.KG hereby declares that this device, to which this user manual belongs, complies with the essential requirements of the standards referred to the Directive **RED 2014/53/EU**. The Declaration of Conformity you find here: **www.technaxx.de/** (in bar at the bottom "Konformitätserklärung"). Before using the device the first time, read the user manual carefully.

This device has a rechargeable battery. It must be fully charged before first use. NOTE: Charge the battery of the device every 2–3 month if it is not used!

Turn OFF nearby Bluetooth devices to avoid signal interference!

WARNING: DO NOT TURN THE VOLUME TOO HIGH – HEARING LOSS MIGHT BE THE RESULT!

Service phone No. for technical support: 01805 012643 (14 cent/minute from German fixed-line and 42 cent/minute from mobile networks).

Free Email: **support@technaxx.de**

Keep this user manual for future reference or product sharing carefully. Do the same with the original accessories for this product. In case of warranty, please contact the dealer or the store where you bought this product.

Warranty 2 years

Enjoy your product * Share your experience and opinion on one of the well-known internet portals such as Amazon or idealo.de

Features

- Multiroom stereo speaker (2x 5W) with built-in Amazon Alexa Voice Service & Bluetooth function
- Voice control via built-in Amazon's cloud based Alexa voice service
- WiFi speaker can connect up to 8 devices receivable within the WiFi network & easy setup of WiFi via APP
- Answers questions, plays music & gives information (e.g. news, weather, sports, traffic, opening hours, etc.)



- Supports mobile phones/Smartphones, PC, Tablets, MP3, etc.
- Music transfer via Bluetooth V2.1 up to 10m
- Audio stream from Spotify, iHeartRADIO, tuneln, TIDAL, etc.
- Custom playlist
- Strong rechargeable 2000mAh battery
- Ideal for use at home or at parties

Technical specification

Bluetooth	V2.1 / transmission range ~10m (open areas)	
WiFi protocol	IEEE 802.11b/g/n	
Frequency band	Bluetooth 2.4GHz–2.480GHz WiFi 2.412GHz–2.484GHz	
Radiated transmission power		Bluetooth max. 4mW WiFi max. 40mW
Functions	Voice assistant, Multiroom speaker, AUX-IN, Bluetooth # Supports DLNA, AirPlay and UPnP # Supports all popular music file formats of external devices (MP3/WMA/WAV/FLAC/RA/AAX/AAC+/APE/etc.)	
Speakers	2x 5W stereo (Ø 5.7cm), SNR ≥ 75dB, impedance 4Ω	
Frequency range	80Hz–20kHz	
Audio input	3.5mm AUX-IN jack	
Power input	DC 5V / 1A	
Power supply	Built-in rechargeable 2000mAh lithium battery 7.4V	
Charging time	~3.5 – 4.5 hours (with Micro USB charging cable)	
Playing time (fully charged)	~5 hours (medium volume 5) ~2.5 hours (maximum volume 10)	
Standby time	~2 months	
Material	ABS plastic + textile	
Weight / Dimensions	1.08kg / (L) 24 x (W) 11.4 x (H) 11.4cm	
Package Contents	MusicMan® WiFi Multiroom Soundstation BT-X34, Micro USB power adapter DC 5V/1A (1m), 3.5mm AUX-IN cable, User Manual	

Product overview

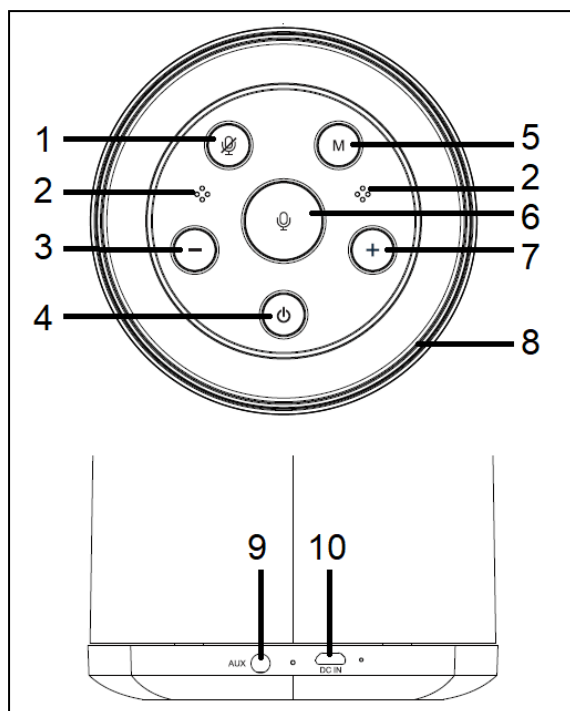







1	Alexa microphone off: Briefly press the button. Hold the button for 3 seconds for factory reset.
2	Microphone
3	Volume down: Press the button ones or hold it to change the volume.
4	Power On/Off: Press the power button for 3seconds to turn the device On or Off.
5	Mode button (Bluetooth/WiFi): Briefly press the button to change between Bluetooth and WiFi mode.
6	Alexa microphone on: Briefly press the button. Hold the button for 3 seconds for factory reset.
7	Volume up: Press the button ones or hold it to change the volume
8	Indicator light: The different colors show the mode or the action that is currently in process.
9	AUX-IN jack
10	Micro USB charging port DC 5V

Speaker light indicator

Speaker mode

- 1 Standby (LED OFF)
- 2 Bluetooth MODE (BLUE)
- 3 AUX mode (GREEN)

	Status	Remark	Light
1	Standby	LED OFF	
2	Listening	Cyan 100% opacity	
3	Thinking	Cyan, blue alternating	
4	Talking	Cyan, blue pulsing	
5	Note	Continually flashing	
6	Notification	Slow yellow pulse	
7	Privacy Mode On	Red 100% opacity	
8	Privacy Mode Off	LED OFF	

Getting started

Press and hold the power button for 3 seconds to turn on the speaker.

You will hear "Power On" "WiFi mode".

15 seconds later you will hear 2 tones, means WiFi is initialized and ready for use.

Configure WiFi connection

Search and download "**MusicMan Multiroom**" from APP Store (iOS) or Google Play Store (Android).



You need the "**MusicMan Multiroom**" APP of the speaker network configuration and also later use of Alexa log in. For more configuration of Alexa use the "Amazon Alexa" APP.

1. Open the "**MusicMan Multiroom**" APP and press the "WiFi Setup Wizard" Button.

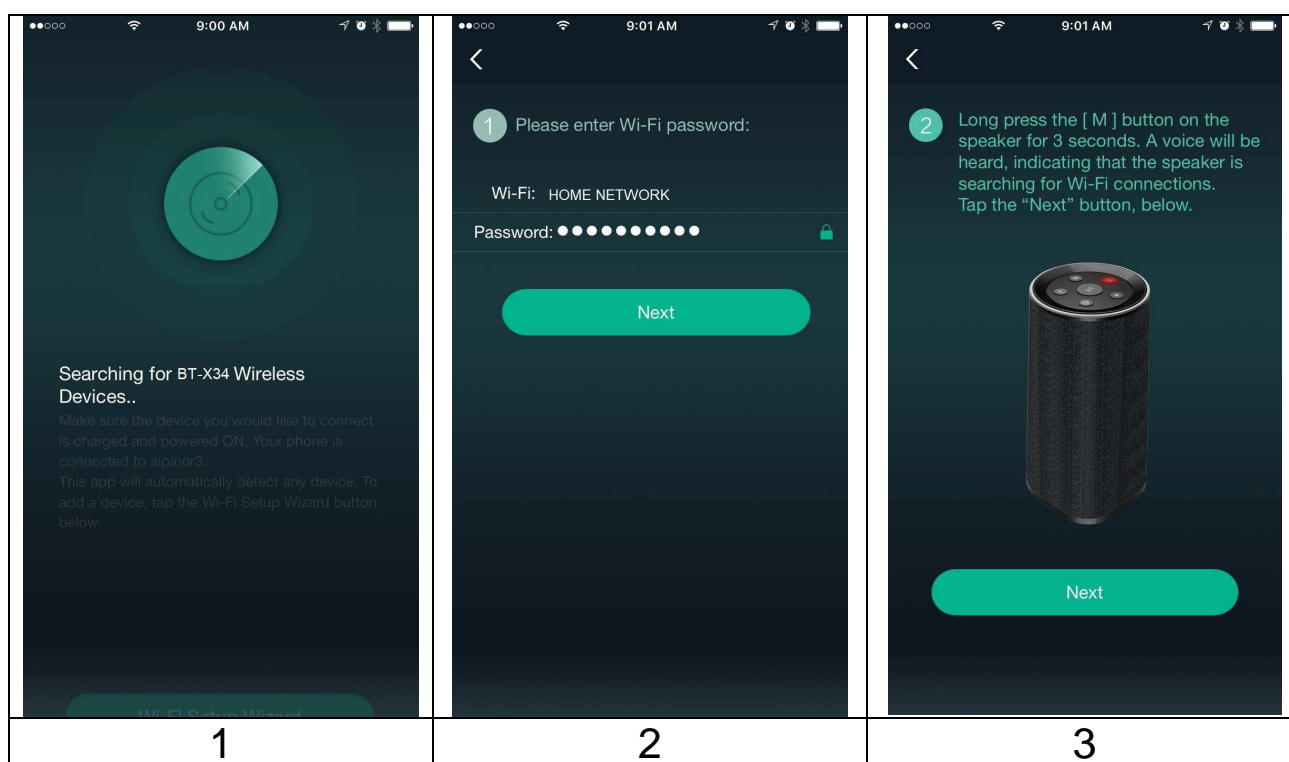

2. Make sure your phone is connected to the 2.4GHz WiFi. 5GHz is not supported. Press NEXT.

3. Enter the password for the WiFi network that your mobile device is connected to and press the NEXT button.

4. Press and hold the M button (Mode button) for over 3 seconds till you hear voice indicator for WiFi connection, press the NEXT button on the screen of your phone.

Note: Do not operate the speaker while in process of WiFi connection.

5. You hear voice confirm when the WiFi has connected successfully.

6. After the WiFi connection is successful choose the name of the device and click NeXT on the top right. After that follow the steps in chapter “**Login to Amazon**”.

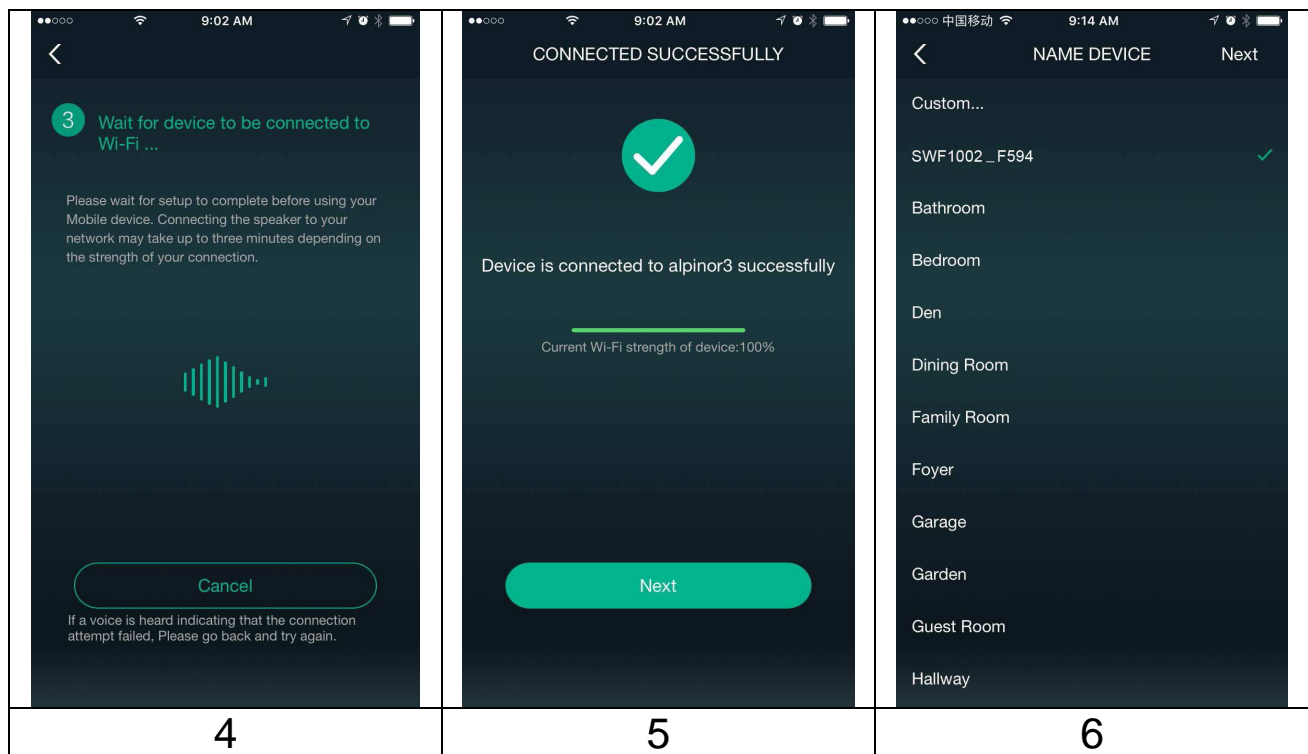

Connection has failed: ● Check if you are really connected with the 2.4GHz WiFi network. ● Otherwise follow the below mentioned steps displayed in the APP after your connection has failed.

Login to Amazon

1. Press "Sign in with Amazon".
2. Enter your Amazon account and password to go on with log in, if you don't have an existing Amazon account, click "Create a new Amazon account" or use this site alexa.amazon.com to register a new Amazon account.
3. Now you see the APP surface. You choose e.g. which source to use playback music.

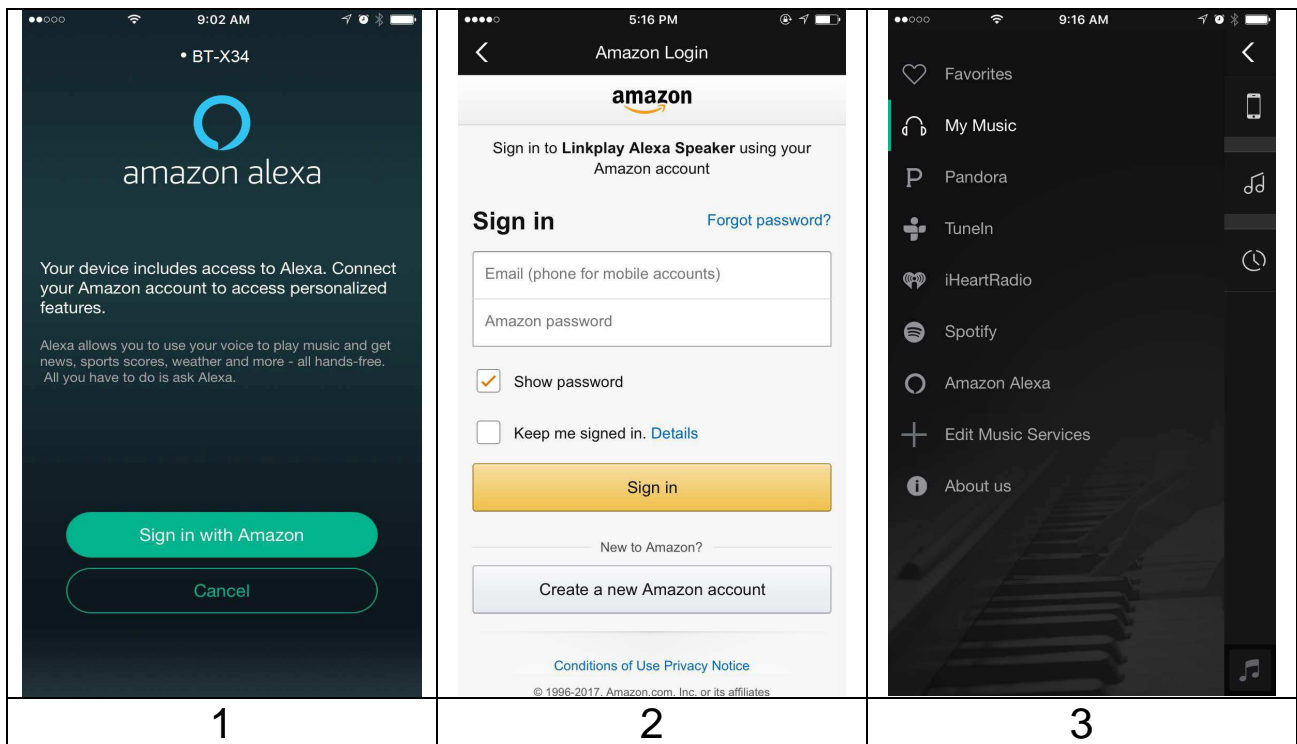

How to use Alexa

	<p>Now you are able to talk to the Speaker. Say "Alexa" to wake up the device. After that ask for the weather for example.</p> <p>For further settings it is recommended to download and install the Amazon Alexa app. Here you can set the right time and place, so your weather data will be correct. You can also click yourself through a big amount of skills that Alexa can use.</p> <p>Note: ● You must call "Alexa" every time before you talk to her. ● A volume of about 70% is the maximum to activate the Alexa voice control, otherwise it is possible that the voice control cannot be activated anymore.</p>
--	---

Multiroom WiFi & Bluetooth Speaker

Adding more speakers to the network and make a group

Press the "+" icon on Device List page on top right hand side. Choose the mode from below and follow steps to add more speakers.

Multi mode

Make one speaker the master and drag others to join it. What is played on the master speaker will be synced to all units in the same group.

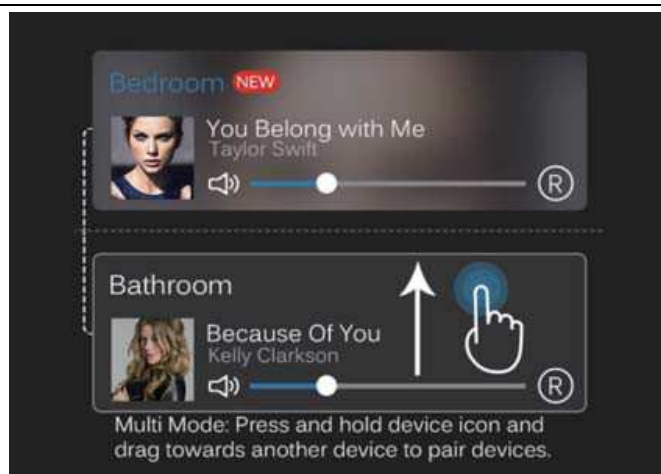

Solo Mode

Separate the speakers and put different soundtracks on each speaker and they play individually.

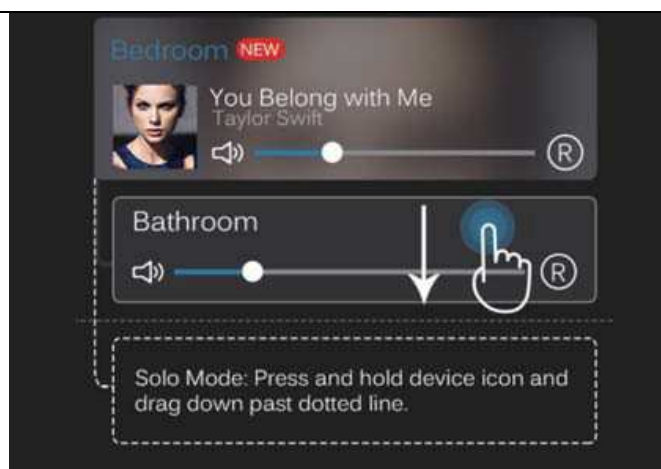

Using the Multiroom in BT mode and AUX-IN mode

When multiple speakers (up to 8) join the same network and a group set up, the multi room is also available in BT/AUX mode. Play music on master speaker through any mode of BT/AUX, the played soundtrack on master speaker will be synced to all other speakers in the same group.

Multiroom WiFi & Bluetooth Speaker

Music continues with DLNA (Android) without a router.

Turn on your speaker. The speaker itself can generate a WiFi signal and can be used as AP (Access Point). In your mobile device's WLAN setting, search the WiFi network "**MusicMan BT-X34**" and connect to it.

Open any DLNA enabled music APP, play any music, click DLNA sharing icon to find devices, choose **MusicMan BT-X34** and cast music to it.

Using Bluetooth

Click briefly the M-button to change speaker to Bluetooth mode, the indicator light starts to blink blue.

Search "**MusicMan BT-X34**" from Bluetooth list and connect to it. You will hear a confirmation tone which confirms Bluetooth connected and the indicator light turns solid blue.

Using AUX-IN

Plug the 3.5mm cable into the AUX port of the speaker and insert the other end into the AUX port of your device. You will hear the message "Auxiliary mode" (AUX-Mode) and the indicator light is green.

Warnings

- If the BT-X34 does not turn on after switching it on, or it turns off after turning it on, check whether the battery is fully charged. If it is OFF power, get it fully charged and try again later. (We suggest charging the BT-X34 all 2-3 month if it is not used for a long time.)

- Only charge the BT-X34 through the DC 5V Micro USB port by using the provided original Micro USB charging cable. You also can use an USB charging adapter but ONLY (!) up to DC 5V/1A. Do not (!) charge the BT-X34 with more power!
- When the BT-X34 works under AUX-IN mode, do not (!) increase the volume of your mobile phone to a large extend. A sound distortion may occur.
- If the BT-X34 fails to link to your mobile device or if it fails to play music after being connected, the user shall check if your mobile device supports A2DP.
- Do not attempt to disassemble the BT-X34, it may result in short-circuit or even damage.
- Do not drop or shake the BT-X34, it may break internal circuit boards or mechanics.
- Keep the BT-X34 in dry and ventilated environment. Avoid high humidity and high temperature. Also batteries should not be exposed to excessive heat or direct sunlight.
- This BT-X34 is not water resistant; therefore keep it away from moisture.
- Keep the BT-X34 away from little children.

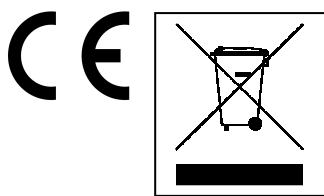

Hints for Environment Protection: Packages materials are raw materials and can be recycled. Do not disposal old devices or batteries into the domestic waste. **Cleaning:** Protect the device from contamination and pollution (use a clean drapery). Avoid using rough, coarse-grained materials or solvents/aggressive cleaner. Wipe the cleaned device accurately. **Distributor:** Technaxx Deutschland GmbH & Co.KG, Kruppstr. 105, 60388 Frankfurt a.M., Germany